

Provide shelving for Storage Room 4070 12" deep 9'-0" long similar to Elevation 65.

See note below with asterisk

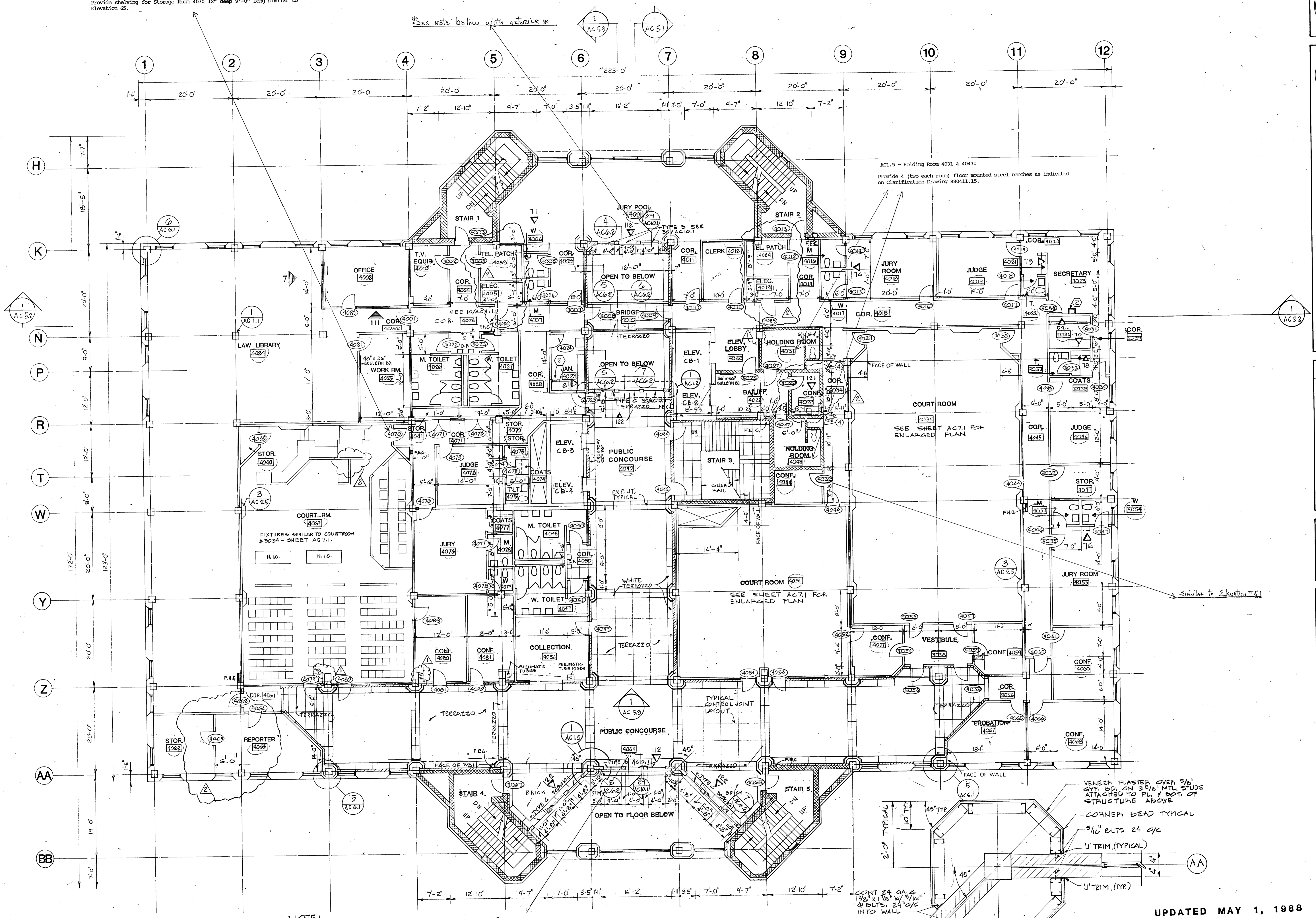

FOURTH FLOOR PLAN

SCALE 1/8" = 1'-0"

NOTE!

▽ DENOTES INTERIOR ROOM ELEVATION. SEE SHEETS ACS.4 - ACS.7

SHEET ACS.5:

* Jury Pool 4001, east and west walls.*
Public Concourse 4064, south wall.

On sheets ACL.2, ACL.3, ACL.4, and ACL.5 in the spaces listed the Brick Masonry Contractor shall provide 16 gauge, 1 1/4" x 3 1/2" galvanized corrugated channel slot anchors at 16" vertically and 24" horizontally keyed into 16 gauge galvanized steel channel slots which shall be attached to existing masonry using 3/8" x 2 1/2" lap shield or 3/8" x 3" Lok/Bolt at 24" on centers. Channel slots shall be equal to Dur-O-Wall D/A 904, or Heckmann No. 133, or Southern Construction Products continuous type. Channel Slot Anchors shall be No. 912 as manufactured by one of the three manufacturers of the channel slots.

BID PACKAGE MAY 1, 1988

NO. 16, FINISH ARCHITECTURAL & MASONRY/SITINGWORK

BID PACKAGE*

NO. 20, KITCHEN & LAUNDRY EQUIPMENT

*Under Contract as of May 1, 1988

UPDATED MAY 1, 1988

BID PACKAGES* JULY 1, 1987

- NO. 08, ELECTRICAL
- NO. 09, PLUMBING
- NO. 10, MECHANICAL
- NO. 11, ROOFING
- NO. 12, MASONRY
- NO. 13, SECURITY SYSTEMS
- NO. 14, ELEVATORS
- NO. 15, STRUCTURAL CONCRETE & MISC. ARCHITECTURAL



WM. F. FREEMAN ASSOCIATES
ARCHITECTS-ENGINEERS-PLANNERS-SURVEYORS
GREENSBORO • HIGH POINT • WINSTON-SALEM

REV	DATE	DESCRIPTION
1	5-1-83	UPDATED
2	6-1-87	PLAN REVISIONS
3	3-15-87	WALL-FLOORING FOR PLUMBING

PROJECT NO. 2350
DATE 12-15-86
SCALE

TITLE
COURTS BUILDING
Fourth Floor Plan

GUILFORD COUNTY GOVERNMENTAL COMPLEX
HIGH POINT, N. C.

SHEET NO.
AC 1.5